

INSTRUCTIONS AND REPAIR PARTS LIST

WFD85 and MFD85 FIELD DRINKER

READ ALL DIRECTIONS CAREFULLY BEFORE BEGINNING INSTALLATION

TOOLS REQUIRED: Adjustable Wrench; Anti-seize compound (Permatex or comparable)

REPAIR PARTS LIST - See Exhibit D on reverse side for location of parts

Ref. No.	Part No.	Description	Quantity
1	WFD851	WFD85 Tank with cover ring, POF	1
2	WFD852	WFD85 Base, POF, Blue	1
1	MFD851	MFD85 Tank with cover ring, Brower	1
2	MFD852	MFD85 Base, Brower, Red	1
	WFD853	Vented Cap for WFD85, including vent plug, includes Ref. Nos. 3 and 4	1
3	WFD853C	Vented Cap, less vent plug	1
4	WFD853P	Vent plug	1
	WFD857	Hardware carton assembly, includes those items with *	
	B78P *	Valve and Float Assembly	
		Includes Ref. Nos. 5, 6, 7, 8, 9, 10, 11, 12, 13, 14, 15 & 16	
	B77P	Valve only. Includes Ref. Nos. 5, 6, 7, 8, 9, 10, 11, 12	
	B79P	Includes Ref. Nos. 14, 15, and 16	
	B81P	Includes Ref. Nos. 6, 7 and 12	
5	A15P *	1 1/4" Hex Delrin Screen	1
6	OF51 *	6-32 Hex Machine Screw Nut, Brass	1
7	B80P *	Cone, Plastic	1
8	B82 *	1/2" ID x 7/8 OD Washer, Rubber	1
9	B83 *	3/4" Conduit Locknut, Zinc	1
10	A19 *	1 1/2 x 1 1/16 Washer, Leather	1
11	B84P *	Valve Body, Plastic	1
12	3B1 *	Hook Rod	1
13	B100 *	1 x 1/8 Cotter Pin, Brass	1
14	W80B11P *	Float Arm, Plastic	1
15	OF116 *	1/4" External Tooth Lockwasher, SS	1
16	OP321 *	Float, Polyethylene	1
17	OP120 *	#11 Solid Stopper, Rubber	3
		(1 Stopper in each drain and 1 stopper in tank)	
18	WFD854 *	Lip Guard	2
19	OF121 *	3/8 ID x 7/8 OD Washer, Zinc - 5/16"	4
20	OF338	5/16-18 x 2 1/2 Hex Head Screw, SS	4
21	OF358 *	3/8 ID x 7/8 OD Washer, SS - 5/16"	4
22	OF310 *	5/16-18 x 3/4 Hex Head Cap Screw, SS	4
	ISHWFD85	Instruction Sheet	1

Possible Valve Hookup (All optional)
 These parts and the valve are not included. You may have another alternative on how to attach a valve. Model 150PP valve can be purchased from us. The other parts are available at most hardware/plumbing stores.

A. Brass 3/4 female garden hose x 3/4 female iron pipe connector.
 B. 3/4 inch conduit nut
 C. 3/4 x 2 1/2 galvanized pipe.
 D. 3/4 inch 90° Street elbows (2)
 See Exhibit A.

EXHIBIT A

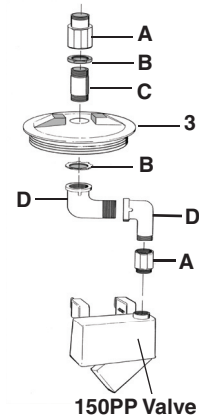

150PP Valve

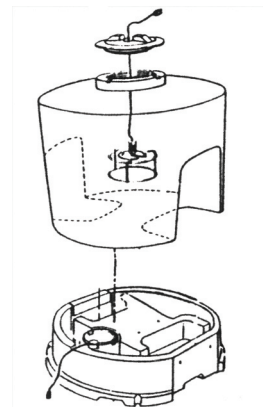

EXHIBIT B

Submerged Heater Options.....

You can use a thermostatically controlled heater in the tank. Electrical supply cord threads easily through port. See Exhibit B.

You can use a cast aluminum de-icer in the trough. We do sell a 250 watt heater which can be used in the base or the tank. Order Model No. OP284P, a C250 Utility Heater. See Exhibit B.

Either option will work for you. In most situations, you do not need both heaters. The trough option, will do a better job with minimal drinking activity (less than say 7 head). Select the option that results in the easiest, most secure hookup for your particular operation. Talk to the heater manufacturer concerning appropriate heater.

MODEL NUMBER

The MODEL NUMBERS are: WFD85 or MFD85 Field Drinker

WHEN ORDERING PARTS

- (1) Show MODEL NUMBER and NAME: Example - WFD85 Field Drinker
- (2) Show PART NUMBER and FULL DESCRIPTION of part: Example - WFD852 Base

HOW TO ORDER PARTS

Repair parts may be ordered from your dealer.



PO BOX 2000 • HOUGHTON, IOWA 52631 • USA

PHONE: 319-469-4141 FAX: 319-469-4402

www.hawkeysteel.com E-MAIL: sales@hawkeysteel.com

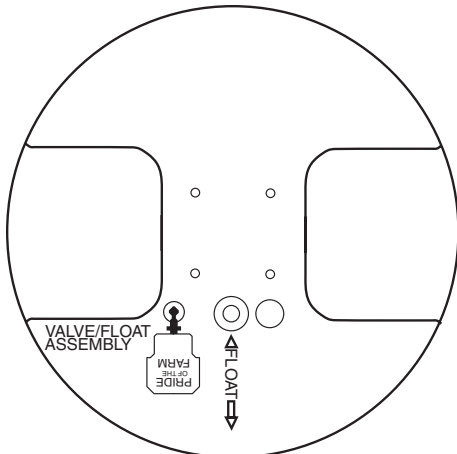

EXHIBIT C

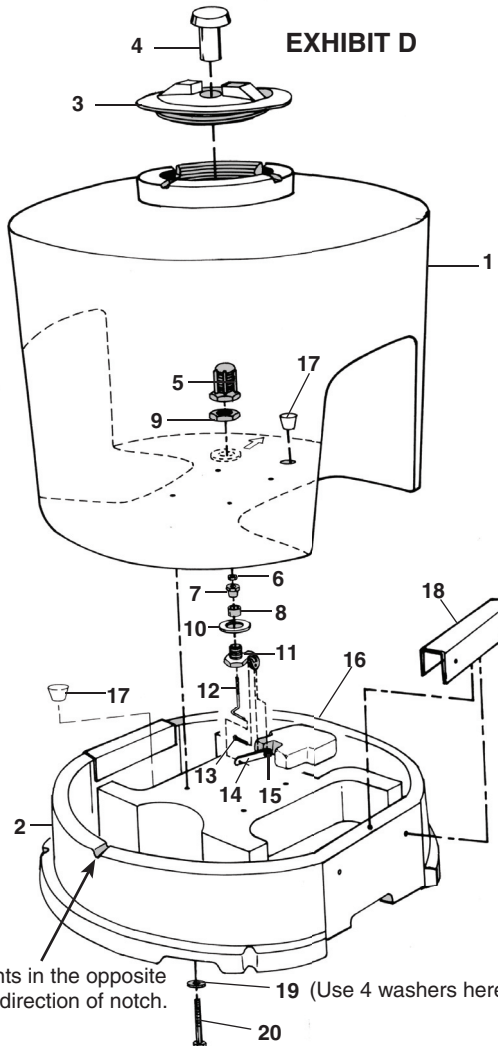
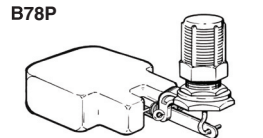

EXHIBIT D



B78P

B78P Plastic Valve and Float

B78P includes:
Ref. Nos. 5, 6, 7, 8, 9, 10,
11, 12, 13, 14, 15, 16

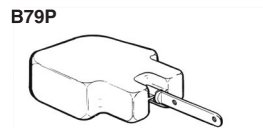

B79P

B79P Plastic Float with Arm

B79P includes:
Ref. Nos. 14, 15, 16

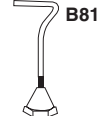

B81

B81 Hook, Rod, Cone and Nut Assembly

B81 includes:
Ref. Nos. 6, 7 and 12

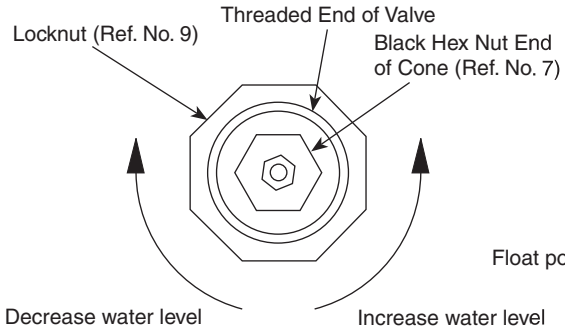
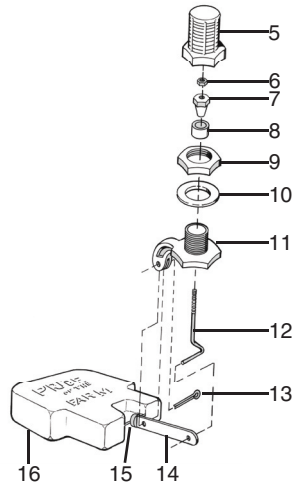

EXHIBIT E



ASSEMBLY INSTRUCTIONS

DO NOT TIGHTEN ANY FASTENERS UNTIL INSTRUCTED TO DO SO!

STEP 1. Check the materials received against the parts list to ensure all parts are present.

STEP 2. Review Exhibit C. Turn the tank over so the bottom is facing you. Locate the B78P Valve and Float assembly. Remove the plastic filter screen (Ref. No. 5), lock nut (Ref. No. 9). Locate the word "FLOAT" on the bottom of the tank. Insert the threaded portion of the valve through the hole in the tank indicated by the arrow. Make sure the float is pointing toward the outside edge of the tank as indicated by the arrow on the tank. See Exhibit C. Thread the lock nut onto the valve and tighten.

CAUTION: Do not over tighten or you may damage the valve.

STEP 3. After the Valve and Float assembly is secure, thread the plastic filter screen onto the valve. This only needs to be finger tight.

STEP 4. Now locate the four (4) 5/16 x 3" hex head bolts (Ref. No. 20) and sixteen (16) 5/16 flat washers (Ref. No. 19) in the hardware supplied. We use extra washers to make it easier to remove the bolts if you need to do so in the future.

NOTE: If you are using a heater in the waterer base, position heater in the base at this time. Make sure the power cord is laying in the notch in the side of the tank base. See Exhibit B.

STEP 5. Lay the waterer tank on it's side. Put the top of the base against the bottom of the tank. Make sure the float is on the opposite side of the base from the power cord notch.

See Exhibit D. Line up the holes in the center section of the base with the threaded inserts molded into the bottom of the tank and attach the base to the tank with the 5/16 x 3" bolts and washers (Ref. Nos. 19 and 20). USE ANTI-SEIZE COMPOUND ON THE THREADS. You may want to remove the fasteners at some point and using this compound will extend the life of the threads. Anti-seize compound is available at most auto parts stores. Tighten the bolts securely. Turn the waterer upright and insert a black rubber stopper (Ref. No. 17) into each drain hole in the drinker openings and the drain hole in the bottom of the tank next to the valve.

STEP 6. Next locate the two (2) stainless steel lip guards (Ref. No. 18) and four (4) 5/16 x 3/4" stainless steel bolts and 5/16 stainless steel flat washers (Ref. Nos. 21 and 22). Place one (1) lip guard, slots facing out, over the trough edge of each drinker opening and secure with the 5/16 x 3/4" stainless steel screws and flat washers.

Note: If you are using a tank heater, remove the vent tube (Ref. No. 4) from the center of the fill hole cap and thread the tank heater power cord through the hole in the cap. See Exhibit B.

STEP 7. Screw the 8" diameter fill hole cap onto the tank after filling the waterer. When full, the recommended water level in the waterer base is 1" below the top edge of the trough. To increase the water level in the trough, remove the plastic filter screen from the valve and turn the black plastic hex nut end of the B80P Cone (Ref. No. 7) counter-clockwise. See Exhibit E. To decrease the water level, turn the end of the B80P cone clockwise. After valve adjustment, be sure to replace the plastic filter screen on the valve.