

# INSTRUCTIONS

## CM500 BELL DRINKER

### CHICKEN & TURKEY LOW PROFILE BELL DRINKER

1. Assemble base & cover parts by simple pressure and fill with sand or gravel. This is not always necessary. Insert the plug into the cover.
2. Screw the stem into the ballast completely.
3. Place spring over stem.
4. Insert water pipe within bell. You may have to push hard, until pipe snaps and seats.
5. Slip stem into the bell through the hole on top of the bell.
6. Insert the valve in top water pipe and thread the nut on the stem. Thread down about halfway. This will probably need to be re-adjusted for water level.
7. Thread the red locknut onto stem and jam against water level control nut in order to avoid loosening.
8. Connect the drinker to water supply with approx. 8' hose (supplied), cut for your use. Two hose connectors and one shut-off saddle are provided.
9. Working pressure: minimum 2PSI, maximum 8PSI. Gravity flow or regulator required.
10. Included with drinker is approx. 10 ft. suspension cord for hanging. Unit can also be used on the floor.
11. Adjust water level in trough by loosening locknut and tightening or loosening water level control nut. Once adjusted, re-tighten locknut.

As you look down at the top of the drinker, turn the water level control nut clockwise to add more water (water will be deeper in the trough). Turning the nut counter clockwise will reduce the water depth.

12. Keep height of bell drinker trough even with the backs of your birds. Adjust height for changing size of bird.

**NOTE: If using bell drinker with bucket supply, drill a hole in lower side of bucket. Hole should be slightly smaller than the diameter of the supplied hose. Pinch hose through hole. Hose should seal itself. You will need not need to shut off.**

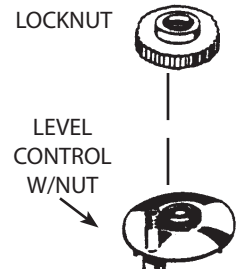
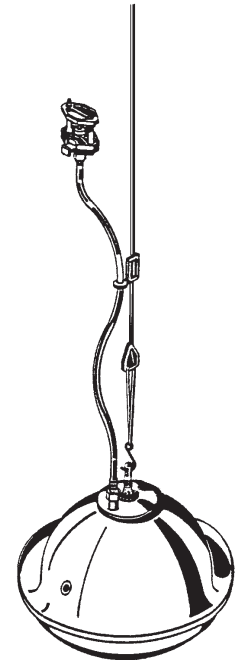
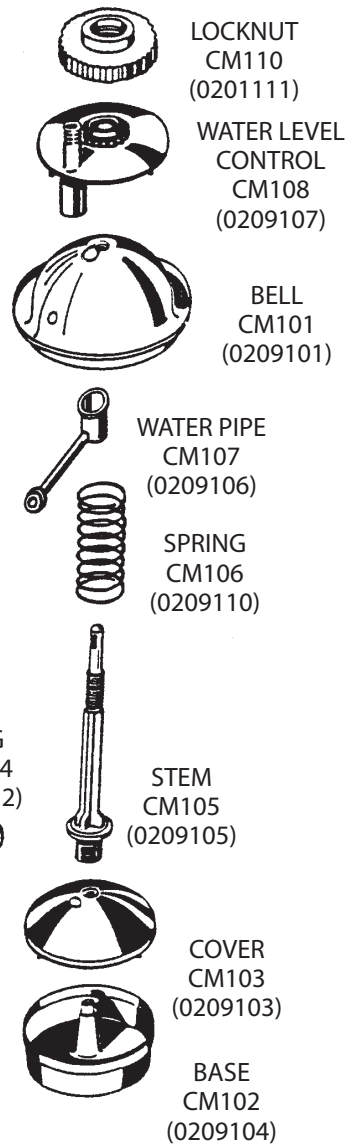

SCREEN →

VALVE BODY →

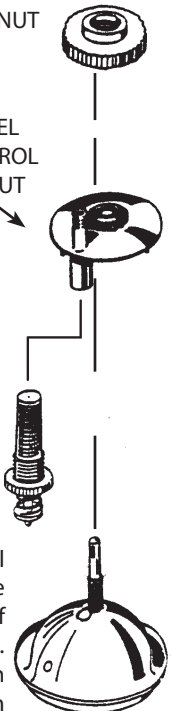

Occasionally the filter screen will plug up not allowing water to the bell trough. Loosen and take off water level control and flip over. Valve body will be located on bottom side of water level control, loosen and take out with fingers. Slip off filter screen and rinse. Reassemble.

